



## 7100 Data Sheet



SERIES: 7000 WOOD COFFERS

STYLE: 7100 CROWN MOLDING

### Overview

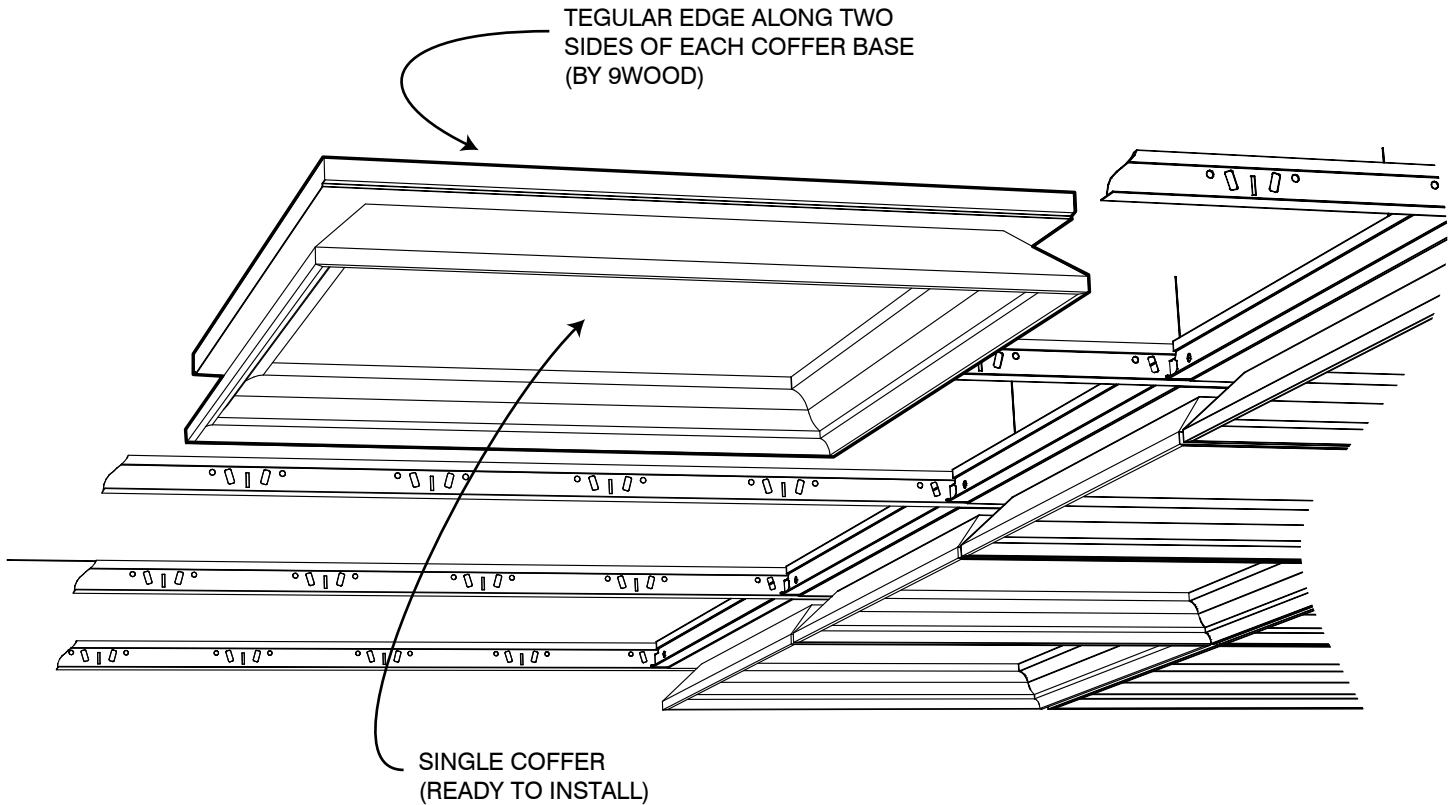

The **7100 Crown Molding Coffers** style wood ceiling offers a classic coffer profile typical of traditional woodworking. The coffer lays into 15/16" standard T-Bar grid below the grid. Multiple veneer pattern options are available for the coffer interior.

**Attachment** for the 7100 Crown Molding Coffers is via tegular edges that lay into T-Bar grid.





## 7100 Data Sheet



SERIES: 7000 WOOD COFFERS

STYLE: 7100 CROWN MOLDING

# Product Data

## Application

The Crown Molding Coffers is often used in spaces where a traditional decorative woodwork ceiling is desired. Picture frame assembly is used to fabricate and miter solid crown molding, which is attached to a veneered panel. A 3/16" reveal is required between panels. Access is by lift, shift and removal. In seismic zones, a safety-wire tie-off may be required.

## Performance

### Acclimatization

Crown Molding Coffers must be cared for in a controlled interior environment (RH 25%-55% max; temp. 60°-80°) and installed only after reaching equilibrium moisture content. Should the building fall outside these limits consult 9Wood, Inc. for our 3 Tests/3 Tracks Acclimatization Advisory.

### Acoustics

The Crown Molding Coffers is considered acoustically reflective.

### Fire Rating

Individual members and components can be treated with Class I (A) Fire Retardant chemicals (solid wood use FR coatings, veneered particleboard use FR formulas). Particular species or styles have not been tested.

### LEED

Crown Molding Coffers may qualify toward MR-3, MR-4.1/4.2, MR-5.1/5.2, MR-6, MR-7, IEQ-4.2 or IEQ-4.4. As all products are custom-fabricated, LEED credit opportunities are project by project. Please contact 9Wood, Inc. for specifics.

### MEP

The Crown Molding Coffers permits MEP penetrations in the ceiling's surface. Cut panels may require supplemental reinforcement. Fixtures and diff users must be independently supported.

### Seismic

Wood Coffers may require a safety wire tie-off. Please consult local code or a licensed engineer for any additional requirements.

### Species & Finishes

9Wood can offer both domestic and imported species for the Crown Molding Coffers. Clear, satin sheen finish is standard; custom stain matches are available.

### Suspension

Crown Molding Coffers lay onto 15/16" heavy duty T-Bar main runners. Main runners are typically 2' on center.

### System Weight

Crown Molding Coffers typically weigh 4 pounds per square foot.



# 7100 Data Sheet



SERIES: 7000 WOOD COFFERS

STYLE: 7100 CROWN MOLDING

## Typical Specifications

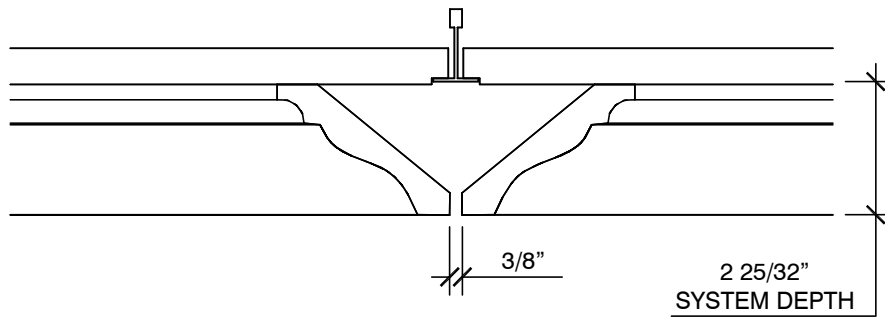

### SKU Table

Coffer Length	Coffer Width		
	24"		
24"	7124-24		

\* Please see [9wood.com](http://9wood.com) for information on appropriate species selections.



# 7100 Data Sheet



SERIES: 7000 WOOD COFFERS

STYLE: 7100 CROWN MOLDING

## Perimeter Conditions and Suspension

